

## HIGH TORQUE HYBRID STEPPING MOTOR SPECIFICATIONS

General specifications		Electrical specifications	
Step Angle ( ° )	1.8	Rated Voltage (V)	3.6
Temperature Rise ( C )	80 Max rated current 2 phaseon)	Rated Current (A)	4
Insulation Resistance ( C )	- 20 +50	Resistance Per Phase ( ±10%Ω )	0.9 (25 C)
Number of Phase	2	Inductance Per Phase ( ±20 % mH )	6.5
Insulation Resistance M ( Ω )	100 Min (500VDC)	Holding Torque (N.m)	8.7
Insulation Class	Class B	Detent Torque (N.m) 2	2.4
Max.radial force (N)	220 (20mm from the flange	Rotor Inertia ( g. cm )	2700
Max.axial force (N)	60	Weight (Kg)	3.8

### Wiring Diagram:

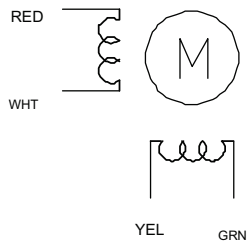

### Pull out torque curve:

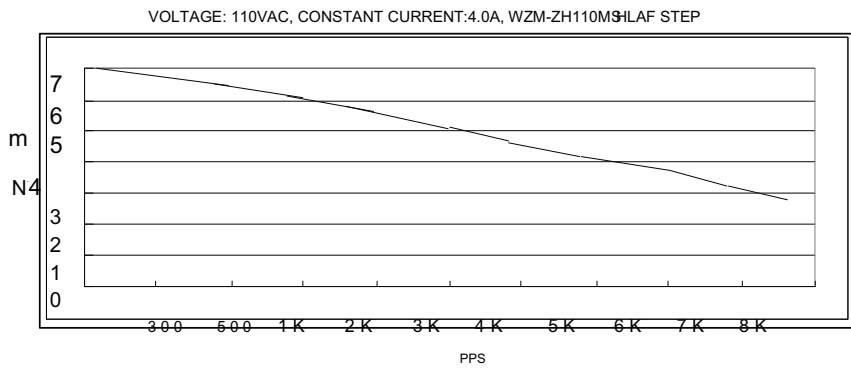

### Dimensions:

(unit=mm)

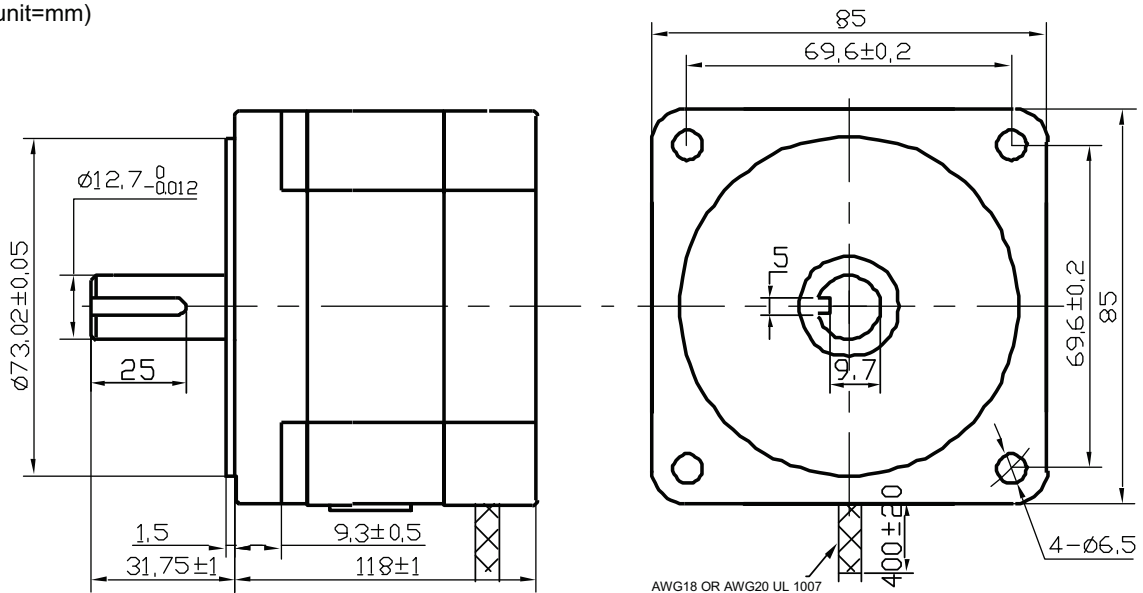

▲									
▲									

87 Kg-cm DC Stepper motor/4A

TECHNICAL CONDITIONS

Yugandhar Systems,Pune  
Email:-info@yugandharsystems.com